



**AMFEC**

AMERICAN FOOD EQUIPMENT COMPANY

[WWW.AMFEC.COM](http://WWW.AMFEC.COM)

# METAL DETECTION

—  
KRS - M-PULSE2

powered by

**p-u-l-s-o-t-r-o-n-i-c**

ANLAGENTECHNIK

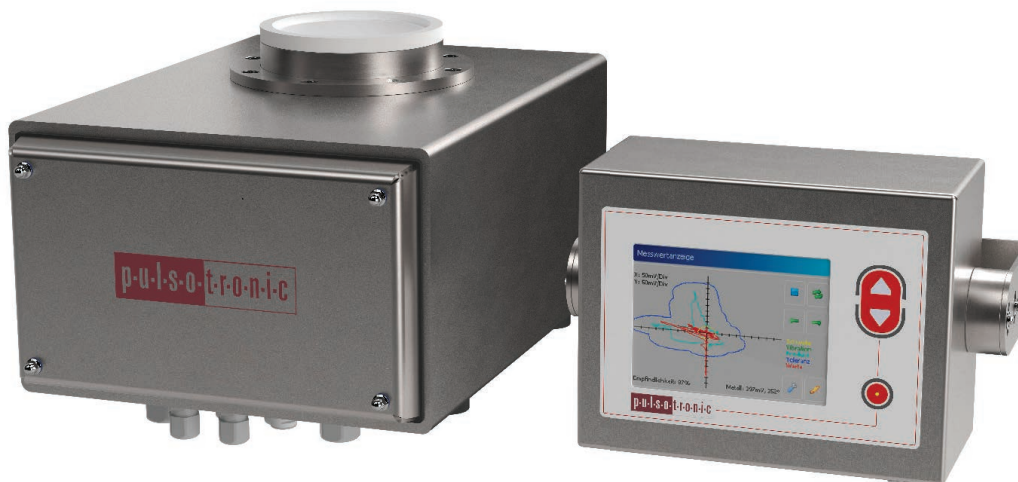

## SPECIAL FEATURES

- compact design
- sensitivity for ferrous and non-ferrous metals from 0.6 mm
- calibration free
- different sizes / shapes available
- protection class IP65
- remote high-performance electronics with product effect suppression
- Ethernet connection
- designed for installation in flow wrapping machines or multihead weighers

## APPLICATION

Due to the low installation height, these all-metal detectors are particularly suitable for installation between the flow wrapping machine and its dosing device.

A direct integration into pipe systems is possible, the ends of the sensor serve at the

same time as a flange. The product tube can be removed without tools and is made of FDA-approved plastic.

## FUNCTION

If metal passes through the sensor, the signal is detected and processed by the evaluation electronics. The electronics are able to detect the smallest metal parts and reliably suppress interfering signals. If metal is detected, this can be signaled by an acoustic or optical encoder.

The control unit is supplied separately and is connected to the probe with a cable up to 5 m long. The control unit can be mounted in an ergonomically favorable position so that the device can be easily operated even in unfavorable space conditions.

## TECHNICAL DATA

Mechanical data								
Device type	KRS100		KRS150		KRS200		KRS250	
Height (L)	245 mm		265 mm		370 mm		420 mm	
Sensor aperture (D)	100 mm		150 mm		200 mm		250 mm	
Diameter (E)	127 mm		177 mm		227 mm		302 mm	
Diameter (F)	110 mm		160 mm		210 mm		260 mm	
Dimensions (A x B)	388 x 286 mm		460 x 358 mm		570 x 468 mm		703 x 600 mm	
(C)	220 mm		300 mm		410 mm		535 mm	
(G)	29 mm		30 mm		30 mm		30 mm	
(H)	36 mm		35 mm		30 mm		35 mm	
metall-free zone (M) for static components for moving components	80 mm 120 mm		120 mm 180 mm		160 mm 240 mm		200 mm 300 mm	
connection	flange / pipe / upper / on inquiry							
Conditions of use								
Storage temperature	-10 – 60°C							
Operating temperature	0 – 60°C							
Protection class	IP65							
Control unit	Supply via control unit; attached with 5 m cable							
Sensitivity <sup>1</sup>								
Material - test pieces	FE	SS	FE	SS	FE	SS	FE	SS
M-Pulse2	0,6	0,9	0,8	1,2	1,0	1,8	1,2	2,0

Order Code (example):    Electronic: M-Pulse2    Sensor: KRS 100 – 150    (e.g.: M-Pulse2 KRS 100)

- 1) The actual sensitivity depends on various factors. Unfavourable environmental conditions or vibrations can reduce the sensitivity. Conductive test material can also influence the sensitivity. For obliging information please contact our service or sales department. our service includes product tests in our headquarters.

TECHNICAL DATA

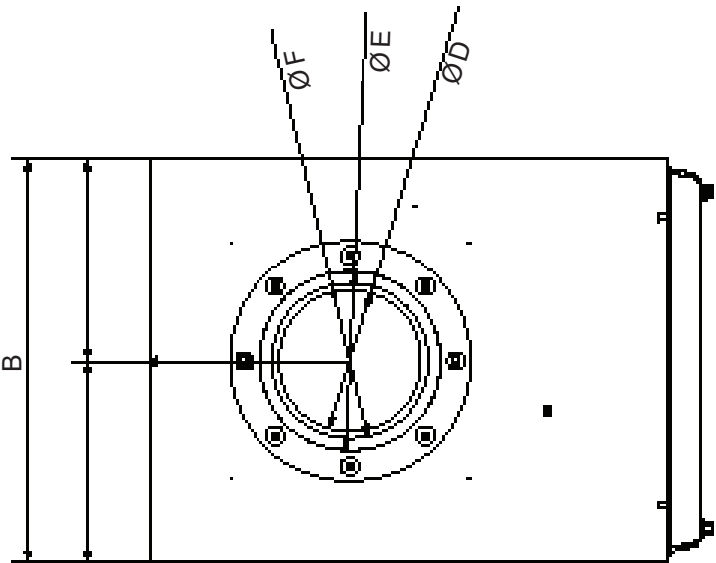
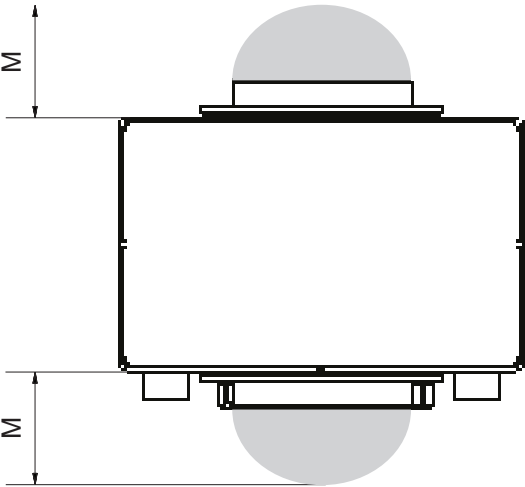
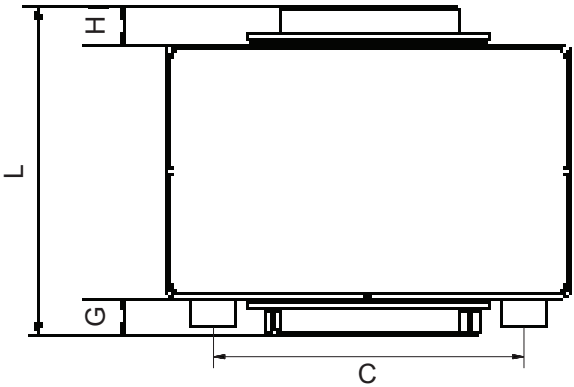
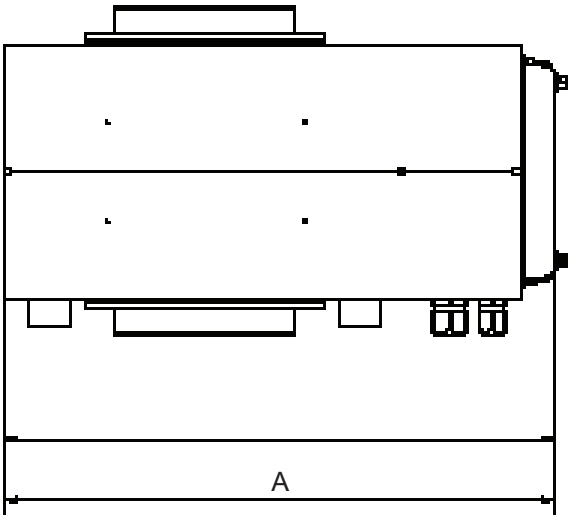

## NOTES



## NOTES

[illegible]

## NOTES

[illegible]



# CUTTING-EDGE TECHNOLOGY IN METAL DETECTION



---

**Phone:**

208-614-6030

**Mail:**

[sales@amfec.com](mailto:sales@amfec.com)

**Website:**

[www.amfec.com](http://www.amfec.com)

**Address:**

4923 East Linden Street  
Caldwell, ID 83605

SEE MORE ON  
OUR WEBSITE

